

BELMONT CASEWORK



Belmont Casework is custom casework provided on a per project basis. Get exactly what you need in the finish you like. Belmont Casework works the best for projects with a minimum of at least 8 cabinets. Provide a floorplan with your quote request that denotes walls so we can design cabinets for your unique space and needs. No floorplan? No problem. SAFFE will help you design your layout.

FEATURES & SPECS

- A floorplan is required to quote casework items.
- Pricing is per project. Individual line item pricing is not provided for Belmont Casework. Project pricing timeline is around 14 days after floorplan is received or created.
- Please provide finish at the time of quoting. Backsplash finish will match countertop.
- Locks are optional, specify if needed.
- Casework items require skilled installers with casework experience. Please see the installation instructions for more information.
- A signoff of the floorplan is required before processing the order to confirm design and room measurements.
- Limited Lifetime Warranty
- Made in the USA

BELMONT CASEWORK: LOWER CABINET OPTIONS

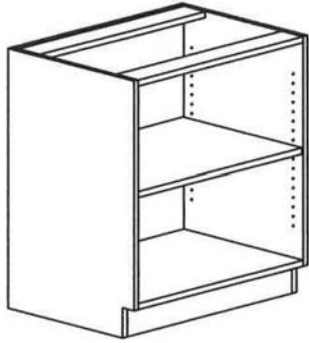

B000: Base Open

Widths: 18, 24, 30, 36, 42, 48

Depth: 24

Heights: 34.5

1 Adjustable Shelf

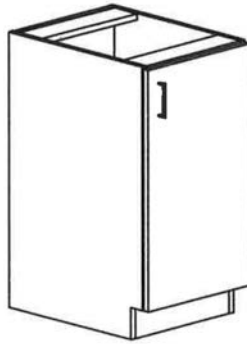

B100: Base Single Door

Widths: 12, 18, 24

Depth: 24

Heights: 34.5

1 Adjustable Shelf

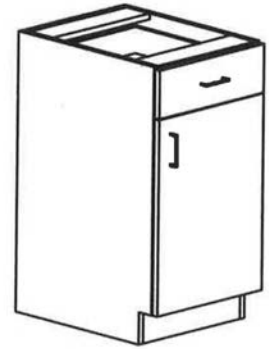

B110: Base Single Door/Drawer

Widths: 12, 18, 24

Depth: 24

Heights: 34.5

1 Adjustable Shelf

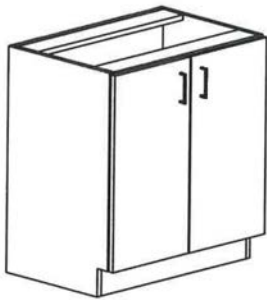

B200: Base Two Door

Widths: 24, 30, 36, 42, 48

Depth: 24

Heights: 34.5

1 Adjustable Shelf



B210: Base Two Door/One Drawer

Widths: 24, 30, 36, 42, 48

Depth: 24

Heights: 34.5

1 Adjustable Shelf



B020: Base Two Drawer

Widths: 18, 24, 30, 36

Depth: 24

Heights: 34.5



B021: Base Two Drawer/One File

Widths: 16

Depth: 24

Heights: 34.5

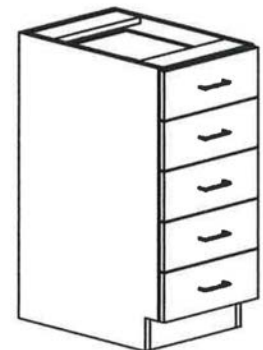

B050: Base Five Drawer

Widths: 24, 30, 36

Depth: 24

Heights: 34.5

BELMONT CASEWORK: UPPER CABINET OPTIONS

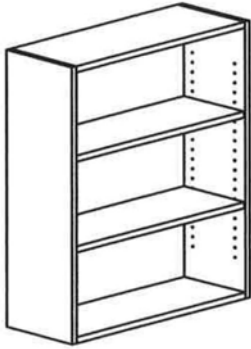

U000: Upper Open

Widths: 18, 24, 30, 36

Depth: 16

Heights: 24, 30

2 Adjustable Shelves

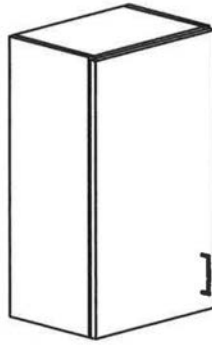

U100: Upper Single Door

Widths: 12, 18, 24

Depth: 16

Heights: 24, 30

2 Adjustable Shelves

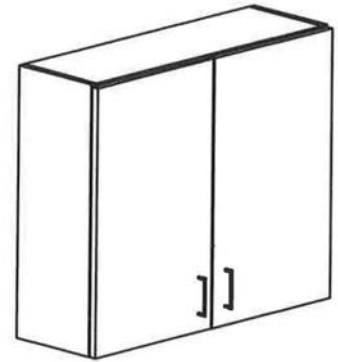

U200: Upper Two Door

Widths: 24, 30, 36, 42

Depth: 16

Heights: 24, 30

2 Adjustable Shelves

BELMONT CASEWORK: TALL CABINET OPTIONS

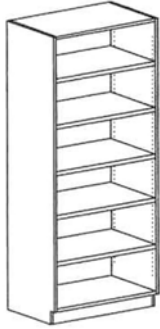

T000: Tall Open

Widths: 18, 24, 30, 36, 42, 48

Depth: 16, 24, 30

Heights: 48, 60, 72, 84, 96

3 Adjustable Shelves: 48 & 60h

4 Adjustable Shelves: 72 & 84h

5 Adjustable Shelves: 96h

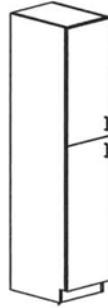

T100DBL: Tall Single Double Door

Widths: 18, 24

Depth: 16, 24, 30

Heights: 48, 60, 72, 84, 96

1 Adjustable Shelf Per Section



T100: Tall Single Door

Widths: 18, 24

Depth: 16, 24, 30

Heights: 48, 60, 72, 84, 96

3 Adjustable Shelves: 48 & 60h

4 Adjustable Shelves: 72 & 84h

5 Adjustable Shelves: 96h

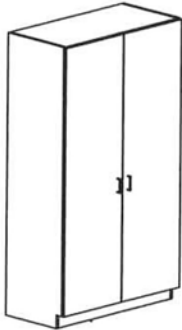

T200: Tall Double Door

Widths: 24, 30, 36, 42, 48

Depth: 16, 24, 30

Heights: 48, 60, 72, 84, 96

3 Adjustable Shelves: 48 & 60h

4 Adjustable Shelves: 72 & 84h

5 Adjustable Shelves: 96h



T200DBL: Tall Two Double Door

Widths: 24, 30, 36, 42, 48

Depth: 16, 24, 30

Heights: 48, 60, 72, 84, 96

1 Adjustable Shelf Per Section

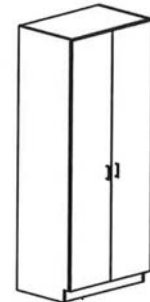

T200TWR: Tall Wardrobe

Widths: 24, 30, 36, 42, 48

Depth: 16

Heights: 48, 60, 72, 84, 96

Default Design: Bar across the top for hanging

Optional Design: Shelf with 2 coat hooks

BELMONT CASEWORK SCOPE INFORMATION

In order to quote a project, a floorplan showing the location of the casework and room walls, and overall room dimensions are helpful. If a floorplan is not available, SAFFE will work with you to draw up your project that can be used as a sign-off sheet. For small projects we have a cabinet scope sheet that can be filled out.

On either the Floorplan or the Cabinet Scope document please denote:

- Cabinet finished ends, for example. Cabinet B220-LFE for left finished end, and B220-RFE for right finished end. Note: a finished end is required if there is not another cabinet being placed beside the cabinet, or the cabinet is not up against a wall.
- Cabinet Model Number
- Cabinet Quantity
- Cabinet Size
- Locking or Non-Locking
- Color Selection

SAMPLE CABINET SCOPE DOCUMENT

ITEM #	QUANTITY	DESCRIPTION	ROOM #	Lock	FINISH
U200	2	Upper Open Cabinet, 24w x 16d x 30h	105	No	Fusion Maple
U200	1	Upper Open Cabinet, 24w x 16d x 30h, LFE	105	No	Fusion Maple
B050	3	Base 5 Drawer Cabinet, 36w x 24d x 34.5h	105	No	Fusion Maple Base & Countertop
B200	2	Base Double Door Cabinet, 36w x 24d x 34.5h	105	No	Fusion Maple Base & Countertop
B200	1	Base Double Door Cabinet, 30w x 24d x 34.5h, LFE	105	No	Fusion Maple Base & Countertop

SAMPLE FLOORPLAN

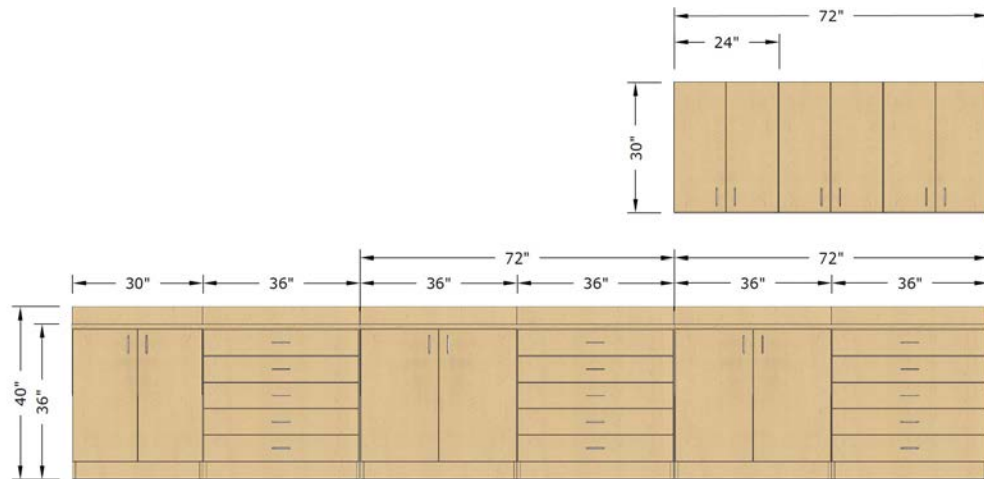

we deliver

SAFFEFURNITURE.COM | 805-SAFFE-MI

BELMONT CASEWORK: CABINET CONSTRUCTION

Cabinet Construction:

- Back: 1/4" industrial grade fiber board with white thermally fused melamine laminate, glued, stapled, and captured at sides.
- Construction: 8mm fluted hardwood dowel; glue, clamp and set square.
- Non-Exposed Sides: 3/4" industrial grade particle board with white thermally fused melamine laminate on both surfaces and 0.5mm PVC exposed edges.
- Exposed/Finished Ends: 11/16" industrial grade particle board with vertical grade laminate on face and white cabinet liner on back with 0.5mm PVC edge.
- Door & Drawer Back Face: white cabinet liner.
- Door & Drawer Face: 11/16" industrial grade particle board core with vertical grade laminate on face, white cabinet liner on back side, and 3mm PVC on edges.
- Cabinet Shelves: 32" wide or less are 3/4" thick, shelves over 32" in length are 1" thick, shelves are white thermally fused melamine 2 sided with .018 PVC EB on front edge that matches exterior cabinet laminate finish.
- Hinge: 120-degree Euro style, self closing, concealed, fully overlay hinge.
- Pull: 4" wire brushed chrome.
- Shelf Clip: Double pin 5mm diameter adjustable clear polycarbonate on 32mm O.C. line bore holes.

Base Cabinets:

- Laminate Countertops: 1 1/8" industrial grade particle board with laminate top and 3mm PVC exposed edges.
- Backsplash is 4" high and matches laminate countertop finish.

Base Cabinets and Tall Cabinets:

- Toe Kick Panel: 4" high, 3/4" industrial grade particle board with thermally fused melamine laminate, doweled between sides; vertical grade laminate strip is supplied matching exterior cabinet finish. Laminate strip is field applied.

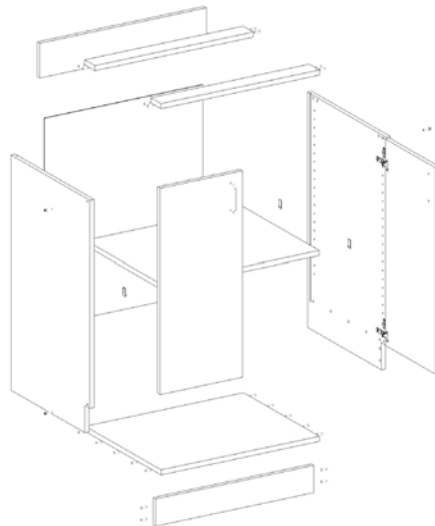

BELMONT CASEWORK CABINET INSTALLATION

SAFFE Furniture does not provide hardware for cabinet installation. The installer is required to provide all appropriate and necessary hardware to secure cabinets in place.

Base & Upper Cabinets: For base and upper cabinets, screw through the backs of the cabinets into wall studs to keep the base cabinets in place. Be sure to screw through the back panel and also through the cross stretchers on the back of the cabinet to ensure a solid foundation.

Cabinet Base Molding: Laminate strips are provided that match the cabinets. These need to be cut to the desired length and adhered to the cabinet surfaces. This method of base molding provides a nice finished look and is the most forgiving for uneven floors.

Countertops: Countertops are fastened to the cabinet by screwing up through the cross braces of the top of the base cabinet into the bottom side of the countertops. Make sure to use the right length screws in order to avoid screwing through the face of the countertops.

Backsplash: Secure to the wall resting on top of the countertop using liquid nails to fasten to the wall.

